

MAP SHOWING THE RESIDUAL LAND FROM P.P. No. 01-016450

Scale 1" = 100'

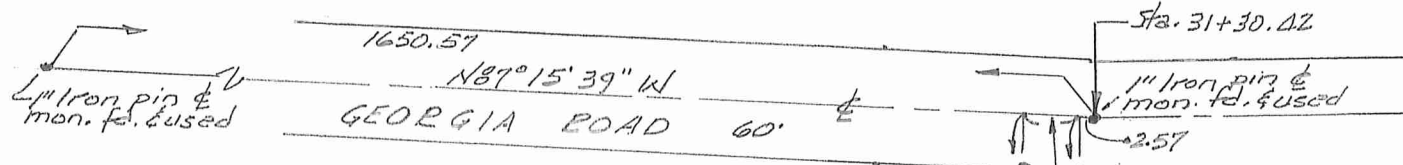

NOTE: For road center line data, see page 8 of the Georgia County Engineers Plan for the Reconstruction of Section A & B of Georgia Road dated 02-05-10

pin set at 30.02' from E
 pin set at 30.02' from E

Stephen E. & Terri L. Evers
 Vol. 761 P. 1052
 P.P. No. 01-090790

John E. & Ruth J. Miller
 Vol. 726 P. 790
 P.P. No. 01-150535

Jon E. & Susan T. Taylor
 Vol. 821 P. 910
 P.P. No. 01-009550

589°32'10" E 607.10 d & used

See Sheet 1
 Match Line
 N81°53'15" W 371.16 d & used

P.P. No. 01-016450

Vol. 1973 P. 3030
 P.P. No. 01-016450

Residual Area 8.359 Ac.
 0.021 Ac. within Rd. R/W

N89°11'15" W 369.40

P.P. No. 01-016450

N89°38'00" W 637.00 d & used

1/2" iron pipe for

Janice D. Farmer, Trustee
 Vol. 1973 P. 3027
 P.P. No. 01-016600

David P. & Lynette E. Mullett
 S.L. 14
 Vol. 1299 P. 1043
 P.P. 01-701300

Jerry L. & Belinda M. Tenney
 S.L. 15
 Vol. 800 P. 183
 P.P. 01-720000

James K. Baker
 S.L. 16
 Vol. 1806 P. 1803
 P.P. 01-119950

Parker H. Sr. & Rebecca A. Strong
 S.L. 17
 Vol. 1357 P. 802
 P.P. 01-091220

George Construction Property Allotment No. 2
 Vol. 7 P. 68-68A Plat Records

Danny Ray & Kristina L. Byler
 Vol. 1941 P. 1447
 P.P. No. 01-090810

N00°53'47" E 400.50

3/4" iron pipe for

Matthew Zaykovsky et al
 Vol. 1814 P. 3290
 P.P. No. 01-149200

2 1/2" iron pipe for

N00°29'00" E

BUR 00246
BUR00246

Farmer, Janice D. (16-055)
Picked Up 05/25/16
Vol. 2041 pg 1814
P# 04-151081

**DESCRIPTION FOR
JANICE D. FARMER, TRUSTEE
New Lot, 6.412 Acres**

Situated in the Township of Burton, County of Geauga, State of Ohio, being part of Original Lots Nos. 68, 69 and 78, within said township, and further described as follows:

Beginning at a 5/8 inch iron pin set, capped "Temple 4761", in the prolongation of the centerline of Erwin Drive, (60 feet in width,) said pin being referenced by a 3/4 inch iron pin found in a monument box at the tangent of a curve, located South 87° 03' 58" West, along said prolongation, and along said centerline, a distance of 506.68 feet, said pin also being the southeast corner of Sub Lot No. 17 of the George Construction Property Allotment No. 2 as recorded in Vol. 7, Pg. 68-68A of the Geauga County Records of Plats, currently in the name of Parker H., Sr. and Rebecca A. Strong, by deed recorded in Vol. 1357 Pg. 802 (P.P. No. 04-091220) of the Geauga County Record of Deeds, said point also being the northwest corner of land conveyed to Jason B. and Nicole M. Wichert by deed recorded in Vol. 1598, Pg. 367, (P.P. No. 04-089900,) of the Geauga County Records of Deeds;

Thence North 46° 12' 30" East, creating a new line, a distance of 49.70 feet, to a 5/8 inch iron pin set, capped "Temple 4761", in the margin of the Erwin Drive Cul-De-Sac;

Thence South 72° 07' 42" East, creating a new line, a distance of 157.37, to a 5/8 inch iron pin set, capped "Temple 4761", in the east line of land conveyed to Janice D. Farmer, Trustee, by deed recorded in Vol. 1973, Pg. 3027, (P.P. No. 04-016600,) of the Geauga County Records of Deeds, said east line also being the Original Lot Line between Lot Nos. 68 and 69;

Thence North 00° 48' 45" East, along the east line of P.P. No. 04-016600, and with said Original Lot Line, passing thru a 1/2 inch iron pipe found, at a distance of 522.92 feet, at the northeast corner of P.P. No. 04-016600, and continuing along the northerly prolongation of said east line, creating a new line, a total distance of 662.92 feet, to a 5/8 inch iron pin set, capped "Temple 4761", at the northwest corner of the parcel herein described;

Thence South 89° 11' 15" East, creating a new line, a distance of 369.40 feet, to a 5/8 inch iron pin set, capped "Temple 4761", in the west line of land conveyed to Matthew Zayakosky, et al by deed recorded in Vol. 1814, Pg. 3290, (P.P. No. 04-149200,) of the Geauga County Records of Deeds;

Thence South 00° 49' 00" West, along the west line of the aforementioned P.P. No. 04-149200, a distance of 724.94 feet, to a 5/8 inch iron pin set, capped "Temple 4761", in the north line of land conveyed to Joseph and Elizabeth Sutyak, by deed recorded in Vol. 1105, Pg. 758, (P.P. No. 04-150836,) of the Geauga County Records of Deeds, said north also being the Original Lot Line between Lot Nos. 69 and 79;

Thence North 88° 52' 30" West, along the north line of said P.P. No. 04-150836, and with said lot line, passing thru a 5/8 inch iron pin found at 136.95 feet, being the northwest corner of said P.P. No. 04-150836 and the northeast corner of the aforementioned P.P. No. 04-089900, and continuing North 88° 52' 30" West, along the north line of said P.P. No. 04-089900, a total distance of 369.36 feet, to a 3/4 inch iron pipe found at an interior angle of said P.P. No. 04-089900, said point also being the common corner for Original Lot Nos. 68, 69, 78, and 79;

Thence South 00° 48' 45" West, continuing along a westerly line of P.P. No. 04-089900, and with the lot line between Lot Nos. 78 and 79, a distance of 31.08 feet, to a 5/8 inch iron pin set, capped "Temple 4761", at an interior angle of said P.P. No. 04-089900;

Thence North 60° 20' 35" West, continuing along a northerly line of P.P. No. 04-089900, a distance 212.15 feet to the place of beginning, passing thru a 5/8 inch iron pin set, capped "Temple 4761", in the margin of the Erwin Drive Cul-De-Sac at a distance of 47.96 feet therefrom, containing within said bounds 6.412 acres of land. The intent is to combine a 6.139 acre Split out of P.P. No. 04-046450, with a 0.273 acre Split out of P.P. No. 04-016600 with 0.032 acre within the road right-of-way, according to the survey of J. Arthur Temple, Registered Surveyor No. 4761, dated May, 2016.

The bearings shown herein are based on an assumed meridian and are used to indicate angles only.

Iron pins set are 5/8 inches in dia. by 30 inches long, with orange caps marked "Temple 4761".

Previous Recordings: 6.139 acres out of Vol. 1973, Pg. 3030, (P.P. No. 04-046450,) and
0.273 acres out of Vol. 1973, Pg. 3027 (P.P. No.04-016600).

Signed: J. Arthur Temple Date May 2016

**SURVEY PLAT & LEGAL DESCRIPTION
APPROVED PER R.C. 315.251**

MWB *05/24/16*
**GEAUGA COUNTY AUDITOR
TAX MAP DEPT.**

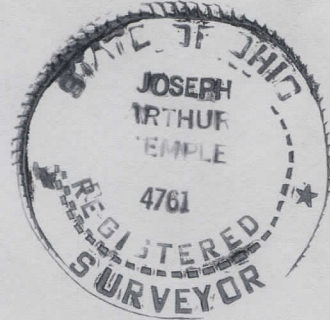

RECEIVED
MAY 23 2016
Geauga County Auditor
Tax Map Dept.

**DESCRIPTION FOR
JANICE D. FARMER, TRUSTEE
Residual Land from P.P. No. 04-016600**

Situated in the Township of Burton, County of Geauga, State of Ohio, being part of Original Lot No. 68, within said township, and further described as follows:

Beginning at a 5/8 inch iron pin set, capped "Temple 4761", in the prolongation of the centerline of Erwin Drive, (60 feet in width,) said pin being referenced by a 3/4 inch iron pin found in a monument box at the tangent of a curve, located South 87° 03' 58" West, along said prolongation, and along said centerline, a distance of 506.68 feet, said pin also being the southeast corner of Sub Lot No. 17 of the George Construction Property Allotment No. 2, as recorded in Vol. 7, Pg. 68-68A of the Geauga County Records of Plats, currently in the name of Parker H., Sr. and Rebecca A. Strong, by deed recorded in Vol. 1357, Pg. 802, (P.P. No. 04-091220,) of the Geauga County Records of Deeds;

Thence South 01° 54' 00" East, along the east line of said P.P. No. 04-091220, passing thru a 5/8 inch iron pin set, capped "Temple 4761", at a distance of 68.20 feet, in the margin of the Erwin Drive Cul-De-Sac, a distance of 510.59 feet, to a 5/8 inch iron pin set, capped "Temple 4761", in a south line of land conveyed to Janice D. Farmer, Trustee, by deed recorded in Vol. 1973, Pg. 3030, (P.P. No. 04-046450,) of the Geauga County Records of Deeds;

Thence South 89° 38' 00" East, along a south line of said P.P. No. 04-046450, a distance of 210.00, to a 1/2 inch iron pipe found at an interior angle of P.P. No. 04-046450, said point also being in the Original Lot Line between Lot Nos. 68 and 69;

Thence South 00° 48' 45" West, along a west line of P.P. No. 04-046450, and with said Original Lot Line, a distance of 522.92 feet, to a 5/8 inch iron pin set, capped "Temple 4761", at the southeast corner of the parcel herein described;

Thence North 72° 07' 42" West, creating a new line, a distance of 157.37 feet, to a 5/8 inch iron pin set, capped "Temple 4761", in the margin of the Erwin Drive Cul-De-Sac;

Thence South 46° 12' 30" West, creating a new line, a distance 49.70 feet, to the place of beginning, containing within said bounds 2.266 acres of land, with 0.033 acre within the road right-of-way, according to the survey of J. Arthur Temple, Registered Surveyor No. 4761, dated May, 2016.

The intent is to describe a 2.266 acre Residual parcel from P.P. No. 04-016600, after a 0.273 acre split.

The bearings shown herein are based on an assumed meridian and are used to indicate angles only.

Pins set are 5/8 inches in dia. by 30 inches long with orange caps marked "Temple 4761".

Previous Recording: Vol. 1973, Pg.3027, (P.P. No.04-016600).

Signed: J. Arthur Temple Date May 2016



**SURVEY PLAT & LEGAL DESCRIPTION
APPROVED PER R.C. 315.251**
Y. M. B. 05/24/16
**GAUGA COUNTY AUDITOR
TAX MAP DEPT.** R

**DESCRIPTION FOR
JANICE D. FARMER, TRUSTEE
Residual Land from P.P. No. 04-046450**

Situated in the Township of Burton, County of Geauga, State of Ohio, being part of Original Lot Nos. 68 and 69, within said township, and further described as follows:

Beginning in the centerline of Georgia Road, (60 feet in width,) at the northwest corner of land conveyed to Jon R. and Susan T. Taylor, by deed recorded in Vol. 821, Pg. 910, (P.P. No. 04-009850,) of the Geauga County Records of Deeds, said point of beginning being referenced by a 1 inch iron pin centerline monument found South 87° 15' 39" East, along said road centerline, a distance of 2.57 feet, said monument being located at Sta. 31+30.42, according to the Geauga County Engineers Plan for the Reconstruction of Section A and B of Georgia Road, dated 02-05-10, said point of beginning also being a point in the Original Lot Nos. 68 and 69;

Thence South 00° 53' 05" West, along the west line of said P.P. No. 04-009850, and with said lot line, passing thru a 5/8 inch iron pin set, capped "Temple 4761", at a distance of 30.02 feet, a distance of 752.36 feet to a 5/8 inch iron pin set, capped "Temple 4761", at the southwest corner thereof;

Thence South 81° 53' 45" East, along a south line of said P.P. No. 04-009850, a distance of 371.16 feet, to a 3/4 inch iron pipe found, in the west line of land conveyed to Matthew Zayakosky, et al, by deed recorded in Vol. 1814, Pg. 3290, (P.P. No. 04-149200,) of the Geauga County Records of Deeds;

Thence South 00° 49' 00" West, along the west line of said P.P. No. 04-149200, a distance of 211.91 feet, to a 5/8 inch iron pin set, capped "Temple 4761", at an angle point, said point being a southwest corner of the parcel herein described;

Thence North 89° 11' 15" West, creating a new line, a distance of 369.40 feet, to a 5/8 inch iron pin set, capped, "Temple 4761", in the aforementioned Original Lot Nos. 68 and 69, said pin being an interior corner of the parcel herein described;

Thence South 00° 48' 45" West, creating a new line and with said lot line, a distance of 140.00 feet, to 1/2 inch iron pipe found, at the northeast corner of land conveyed to Janice D. Farmer, Trustee, by deed recorded in Vol. 1973, Pg. 3027, (P.P. No. 04-016600,) of the Geauga County Records of Deeds;

Thence North 89° 38' 00" West, along the north line of said P.P. No. 04-016600, and along the north line of the George Construction Property Allotment No, 2, as recorded in Vol. 7, Pg. 68-68A of the Geauga County Records of Plats as follows:

Sub Lot #17, currently in the name of Parker H. Sr. and Rebecca A. Strong, by deed recorded in Vol. 1357, Pg. 802, (P.P. No. 04-091220,) of the Geauga County Records of Deeds;

Sub Lot #16, currently in the name of James K. Baker, by deed recorded in Vol. 1806, Pg. 1808, (P.P. No. 04-119950,) of the Geauga County Records of Deeds;

Sub Lot #15, currently in the name of Jerry L. and Belinda M. Tenney, by deed recorded in Vol. 800, Pg. 183, (P.P. No. 04-720000,) of the Geauga County Records of Deeds;

Sub Lot #14, currently in the name of David P. and Lynette E. Mullett, by deed recorded in Vol. 1299, Pg. 1043, (P.P. No. 04-701300,) of the Geauga County Records of Deeds; and part of

Sub Lot No. 13, currently in the name of Michael Zabukovec, by deed recorded in Vol. 1997, Pg. 2617, (P.P. No. 04-047500,) of the Geauga County Records of Deeds;

a total distance of 637.00 feet, to a 5/8 inch iron pin set, capped, "Temple 4761", being the southeast corner of land conveyed to Danny Ray and Kristina L. Byler, by deed recorded in Vol. 1941, Pg. 1467, (P.P. No. 04-090810,) of the Geauga County Records of Deeds;

Thence North 00° 58' 47" East, along the east line said P.P. No. 04-090810, a distance of 400.50 feet, to a 5/8 inch iron pin set, capped "Temple 4761", at the southwest corner of land conveyed to Stephen E. and Terri L. Evers by deed recorded in Vol. 761, Pg. 1052, (P.P. No. 04-090790,) of the Geauga County Records of Deeds;

Thence South 89° 32' 10" East, along the south line of said P.P. No. 04-090790, and along the south line of land conveyed to John E. and Ruth J. Miller, by deed recorded in Vol. 726, Pg. 790, (P.P. No. 04-150535,) of the Geauga County Records of Deeds, a distance of 607.10 feet, to a 5/8 inch iron pin set, capped "Temple, 4761", at the southeast corner thereof;

Thence North 00° 53' 05" East, along the east line of said P.P. No. 04-150535, a distance of 753.16 feet, to the centerline of Georgia Road, passing thru a 5/8 inch iron pin set, capped "Temple, 4761", a distance of 30.02 feet therefrom;

Thence South 87° 15' 39" East, along said road centerline, a distance of 30.00 feet, to the place of beginning, containing within said bounds 8.359 acres of land, with 0.021 acres within the road right-of-way, according to the survey of J. Arthur Temple, Registered Surveyor No. 4761, dated May, 2016.

The intent is to describe a 8.359 acre Residual parcel from P.P. No. 04-046450 after a 6.139 acre split.

The bearings shown herein are based on an assumed meridian and are used to indicate angles only.

Pins set are 5/8 inches in dia. by 30 inches long with orange caps marked "Temple 4761".

Previous Recording: Vol. 1973, Pg. 3030, (P.P. No.04-046450)

Signed: J. Arthur Temple Date May 2016

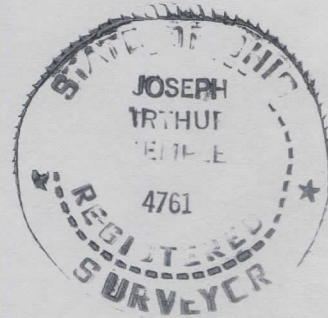

SURVEY PLAT & LEGAL DESCRIPTION
APPROVED PER R.C. 315.251
[Signature] 05/24/16
GEAUGA COUNTY AUDITOR
TAX MAP DEPT.

